

**SERVICE MANUAL AND PART LIST**

**'BROWNIE' 44A**

**and**

**44B CAMERAS**

**Kodak**

**EQUIPMENT  
SERVICES**



---

## SERVICE MANUAL AND PART LIST

# 'BROWNIE' 44A

and

# 44B CAMERAS

---

### CONTENTS

	<i>Page</i>
<b>I SPECIFICATION</b>	
1.1 Camera body and covers . . . . .	1
1.2 Camera lens (44A) . . . . .	1
1.3 Camera lens (44B) . . . . .	1
1.4 Shutter (44A) . . . . .	1
1.5 Shutter (44B) . . . . .	1
1.6 Viewfinder . . . . .	1
1.7 Film transport . . . . .	2
1.8 Lubrication . . . . .	2
<b>2 SERVICING</b>	
2.1 Possible camera faults . . . . .	3
2.2 Double-exposure prevention mechanism . . . . .	3
2.3 Shutter and lens assembly . . . . .	3
2.4 Optical system . . . . .	4
2.5 Flash synchronization . . . . .	4
<b>3 PART LIST</b> . . . . .	5

Made in England by Kodak Limited London

# SPECIFICATION

The 'Brownie' 44A and 44B cameras are very similar in design, both taking 12 exposures on 127 film (negative size  $1\frac{5}{8}$  in  $\times$   $1\frac{5}{8}$  in). The two models differ mainly in the type of lens and shutter fitted.

## 1.1 Camera body and covers

Body—Black polystyrene moulding with black grained rexine covering.

Base and top cover—Grey polystyrene mouldings.

Back—Pressed aluminium with black grained rexine covering.

## 1.2 Camera lens (44A)

(a) Type—'Dakon' meniscus, moulded in acrylic resin.

(b) Aperture— $f/11$  and  $f/16$  (5 ft to infinity and 4 ft to infinity). The settings are indicated by exposure value numbers '12' and '13' respectively, printed on the nameplate.

## 1.3 Camera lens (44B)

(a) Type—'Anaston'  $f/8$ , triplet, with front element focusing. The front and rear elements are moulded in clear acrylic resin and the centre element is glass.

## 1.4 Shutter (44A)

(a) Type—Single-speed, everset type fitted with flash contacts.

(b) Speed—Approximately  $1/40$ th second (20 to 30 milliseconds effective exposure time). Should be checked in accordance with B.S.1592: 1958 ( $\pm 20\%$ ).

(c) Synchronization—Suitable for Class M flashbulbs.

## 1.5 Shutter (44B)

(a) Type—Self-setting, two-speed, fitted with flash contacts and double-exposure prevention device.

(b) Speed— $1/30$ th second,  $1/60$ th second and brief time. Should be checked in accordance with B.S.1592: 1958 ( $\pm 20\%$ ).

(c) Synchronization—Suitable for Class M flashbulbs.

## 1.6 Viewfinder

(a) Type—Optical, direct vision.

(b) Front lens—Moulded in acrylic resin.

Rear lens—Glass.



## Removal

Remove the winding knob, felt washer and top cover (screws D24031, 2127-006-39 and 2127-104-35). Then remove the four screws (2127-103-35) and the two screws (2127-101-35) securing the camera front to the body and remove the complete body front, shutter and lens assembly.

### Model 44A

Remove the shutter cover (D23964); the shutter mechanism is now accessible.

### Model 44B

- (a) Remove the baffle plate (D24476) and three screws (2127-103-35 and 2127-101-35) and remove the shutter and lens assembly from the body front.
- (b) Remove the three screws (D23935) and remove the lens plate (D24470), focusing rim (D24469), focusing scale (D24472) and the front lens element (C23994). Remove the circlip (D27421), the front plate (C23993) and the speed setting ring (D25495).  
The shutter mechanism is now accessible.
- (c) Remove the two screws (2133-512-20) from the shutter housing and remove the shutter assembly (C23938) from the housing. The rear lens elements, shutter blade and flash connections are now accessible.

## Replacement

- (d) Replace the assembly by reversing the sequence of the removal operations.
- (e) Model 44B—Check the operation of the shutter push pin and the action of the double-exposure prevention mechanism.

Lubricate the threads of the front lens element and check the focusing movement through the complete scale. Check the camera focusing (Operation 2.4).

## 2.4 Optical system

### Cleaning

The front viewfinder lens and the 44A camera lens are made from acrylic materials and should therefore be cleaned carefully.

### Lens focusing

- (a) Model 44A  
No focusing is required as the lens is permanently positioned.
- (b) Model 44B  
Test—Check the focusing at 20 ft using a ground glass plate and a focusing chart or clearly defined object. As the film plane in the camera is curved, focusing can be checked only in the centre of the field.

Adjustment—Slacken the three screws (D23935) in the lens plate (D24470) and move the focusing scale to the correct reading. When correct, tighten the screws taking care not to move the focusing scale.

## 2.5 Flash synchronization

Flash synchronization of the shutter is controlled by accurately pre-formed parts and adjustment is not practicable. Normally if the shutter is within the speed tolerance and an adequate contact is made, synchronization will be satisfactory.



# 3

# PART LIST

All orders for service parts of photographic equipment made by Kodak Limited should be sent to:

**KODAK LIMITED**

**Equipment Services**

**STEVENAGE**

**HERTFORDSHIRE**

When ordering parts, give the name of the camera and the number of the part.

Service parts are listed as Replacement Units. These units may consist of two or more parts which are permanently secured together. If an order for one of these parts is received, the replacement unit which contains that part will be sent.

**REPLACEMENT UNITS** (continued)

<i>Part Number</i>	<i>Name of Part</i>	<i>Model</i>	<i>Quantity Required</i>
D 24002	Locking Lever No. 2	B	1
D 24003	Retaining Plate	B	1
D 24006	Shutter Slide Spring	B	1
D 24008	Shutter Operating Slide	B	1
D 24009	Slide Shim	B	1
D 24010	Latch Stud (Camera Back)	A, B	1
D 24012	Rivet (Hinge to Back)	A, B	2
D 24013	Rivet (Hinge to Body and Contact)	A, B	1
B 24018	'Ever-ready' Cover	A, B	1
D 24019	Aperture Plate (part of C23939)	B	1
D 24021	Finder Lens Mask	A, B	1
D 24022	Shouldered Stud (Spool Latch)	A, B	1
D 24023	Leak Light Strip	A, B	1
D 24024	Shutter Blade	A	1
D 24029	Packing for Hinge	A, B	1
D 24030	Rear Finder Lens	A, B	1
D 24031	Winding Knob Securing Screw	A, B	1
D 24033	Spacing Washer (between Lens and Front Plate)	A	1
D 24034	Rivet (Base Cover to Body)	A, B	2
D 24036	Lens Housing Assembly	A	1
D 24037	Back Assembly	A, B	1
C 24038	Body Front and Shutter Assembly	A	1
C 24039	Top Cover Assembly (includes Finder Lenses)	A, B	1
B 24040	Body Assembly (includes Winding Key Housing, Contacts and Hinge)	A	1
D 24042	Latch Assembly	A, B	1
D 24463	Shutter Return Spring	A	1
D 24465	Capping Blade Assembly (includes Stud and Spring)	A	1
D 24466	Key Post and Clutch Assembly (includes Spring and Post) (For Models without Retaining Plate)	A, B	1
D 24467	Neck Strap Assembly	A, B	1
D 24469	Focusing Rim	B	1
D 24470	Lens Plate	B	1
D 24472	Focusing Scale	B	1
C 24475	Base Cover	B	1
D 24476	Baffle Plate	B	1
D 24478	Blade Controller Assembly	B	1
B 24591	Body Front Assembly (includes Connecting Strips)	B	1
D 25481	Foam Washer	A, B	1
C 25492	Shutter and Lens Assembly (includes C23938, C23939, C23993, C23994, D25495)	B	1
C 25493	Body Front, Shutter and Lens Assembly	B	1
D 25494	Key Post and Clutch Assembly (Models fitted with Retaining Plate (D24003) )	B	1
D 25495	Speed Setting Ring Assembly	B	1



**REPLACEMENT UNITS** (continued)

<i>Part Number</i>	<i>Name of Part</i>	<i>Model</i>	<i>Quantity Required</i>
D 25499	Shouldered Stud (Capping Blade)	A	1
D 26399	Felt Washer	A, B	1
D 26416	Mechanism Plate and Stud Assembly	B	1
D 27420	Shouldered Stud (Bulb Lever)	B	1
D 27421	Circlip, $\frac{7}{8}$ " Bowed External (Salter 5101-87)	B	1
93121	Rivet (Spool Tension Spring to Body)	A, B	1

**SMALL PARTS**

<i>Part Number</i>	<i>Name of Part</i>	<i>Model</i>	<i>Quantity Required</i>	<i>Where used</i>
<b>SCREWS</b>				
2126-814-39	Drive Screw, No. $0 \times \frac{1}{4}$ " Rd. Hd. PK, Type U Chromium Plated	A, B	1	1-Latch Cover
2126-823-35	Drive Screw, No. $2 \times \frac{3}{16}$ " Rd. Hd. Black	B	1	1-Key Post
2127-003-35	No. $2 \times \frac{1}{4}$ " Csk. Hd. Recessed, PK Type Z, Black	A	3	3-Lens Housing
2127-006-39	No. $2 \times \frac{1}{2}$ " Csk. Hd. Recessed, PK Type Z, Chromium Plated	A, B	1	1-Top Cover
2127-101-35	No. $2 \times \frac{1}{8}$ " Pan Hd. Recessed, PK Type Z, Black	A, B	5	3-Flash Contacts 2-Spool Cradle
2127-102-35	No. $2 \times \frac{3}{16}$ " Rd. Hd. Recessed, PK Type Z, Black	A, B	4	2-Winding Key Housing 2-Retaining Plate (B)
2127-103-35	No. $2 \times \frac{1}{4}$ " Pan Hd. Recessed, PK Type Z, Black	A, B	6	4-Body Front 2-Shutter Housing
2127-104-35	No. $2 \times \frac{5}{16}$ " Pan Hd. Recessed, PK Type Z, Black	A, B	1	1-Top Cover
2133-512-20	10BA $\times \frac{3}{16}$ " Ch. Hd. Steel, Black	B	2	2-Mechanism Plate
2133-515-62	10BA $\times \frac{3}{8}$ " Ch. Hd. Brass	B	1	1-Mechanism Plate



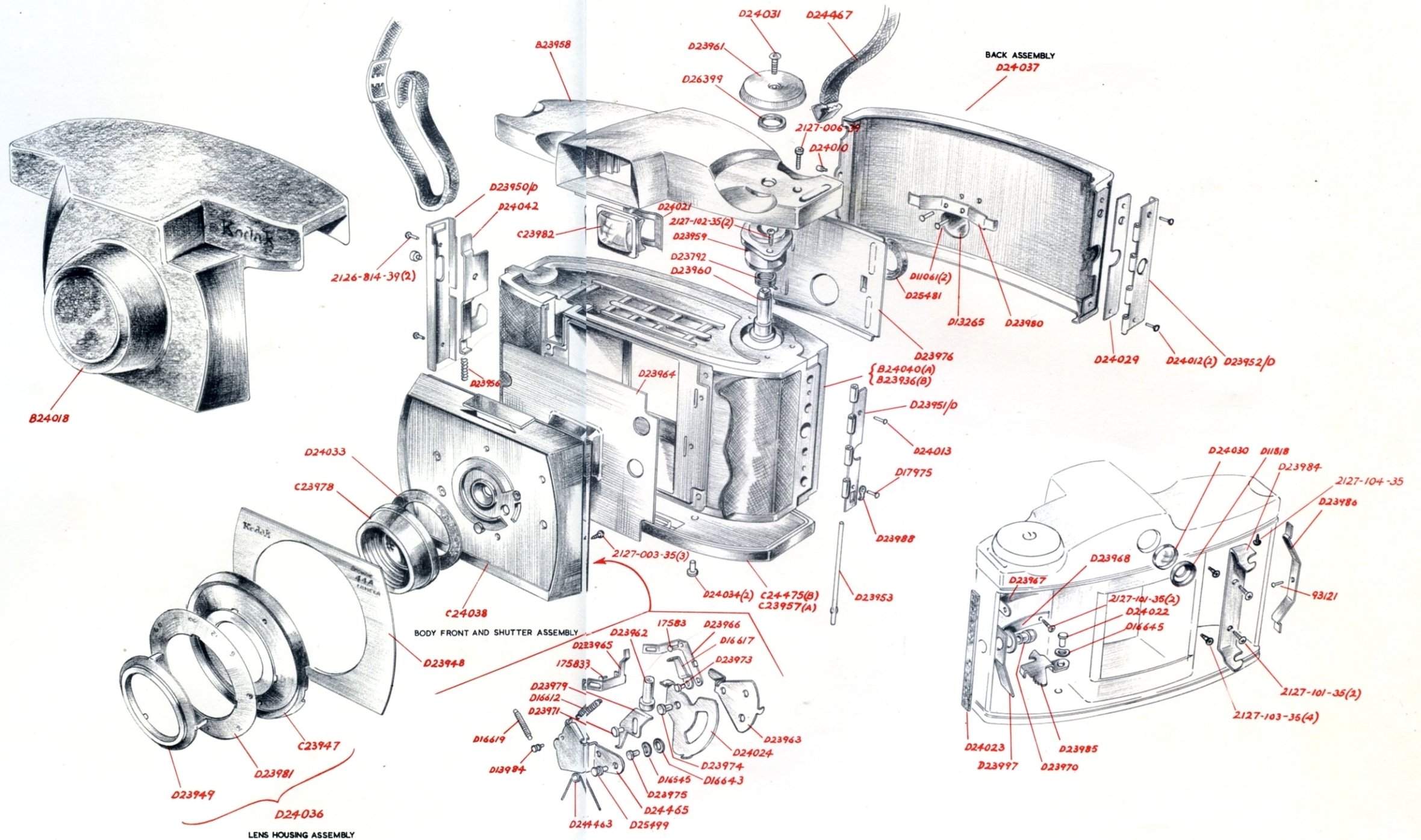

THE BODY FRONT AND SHUTTER ASSEMBLY IS FOR MODEL 44A ONLY FOR DETAILS OF MODEL 44B BODYFRONT, SHUTTER AND LENS ASSEMBLY SEE SHEET 2.



LOCKING LEVERS

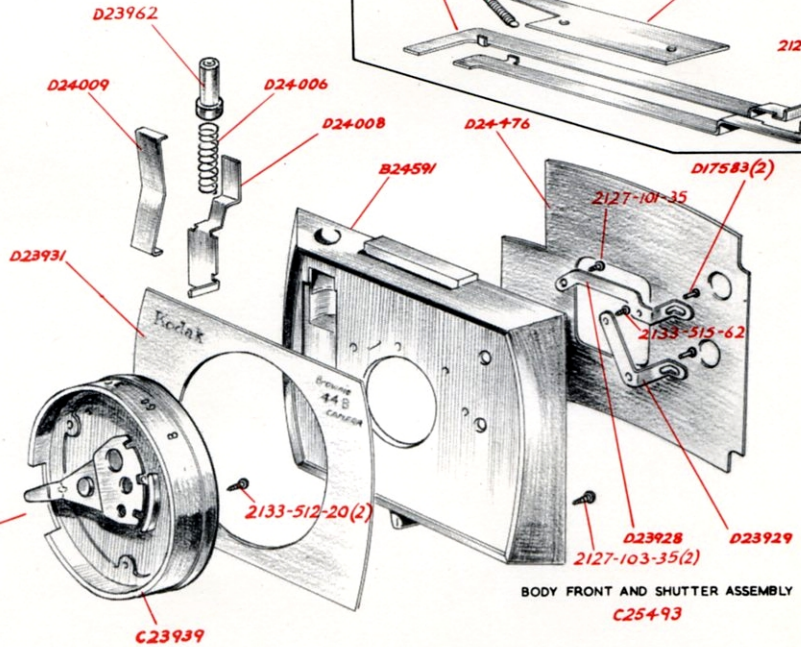
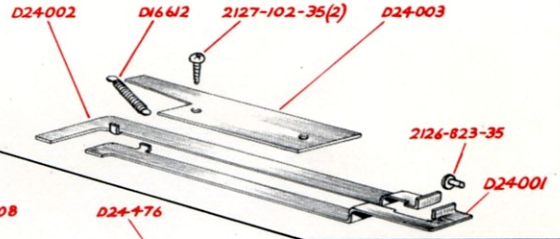

BODY FRONT AND SHUTTER ASSEMBLY  
C25493

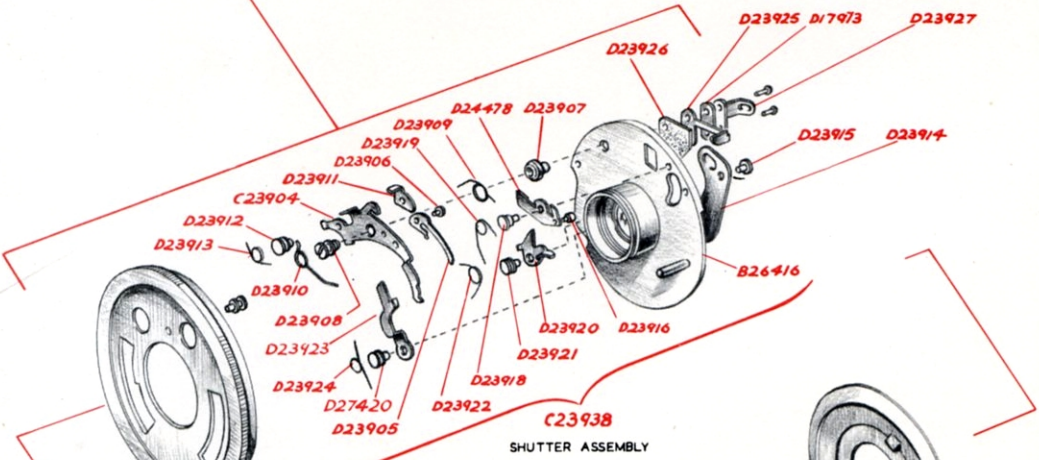

SHUTTER ASSEMBLY

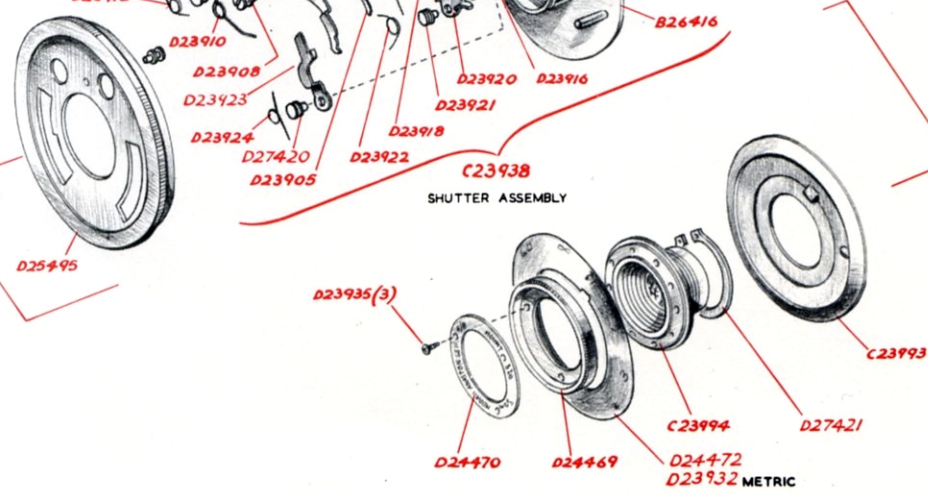

FOR DETAILS OF CAMERA BODY SEE SHEET 1

